

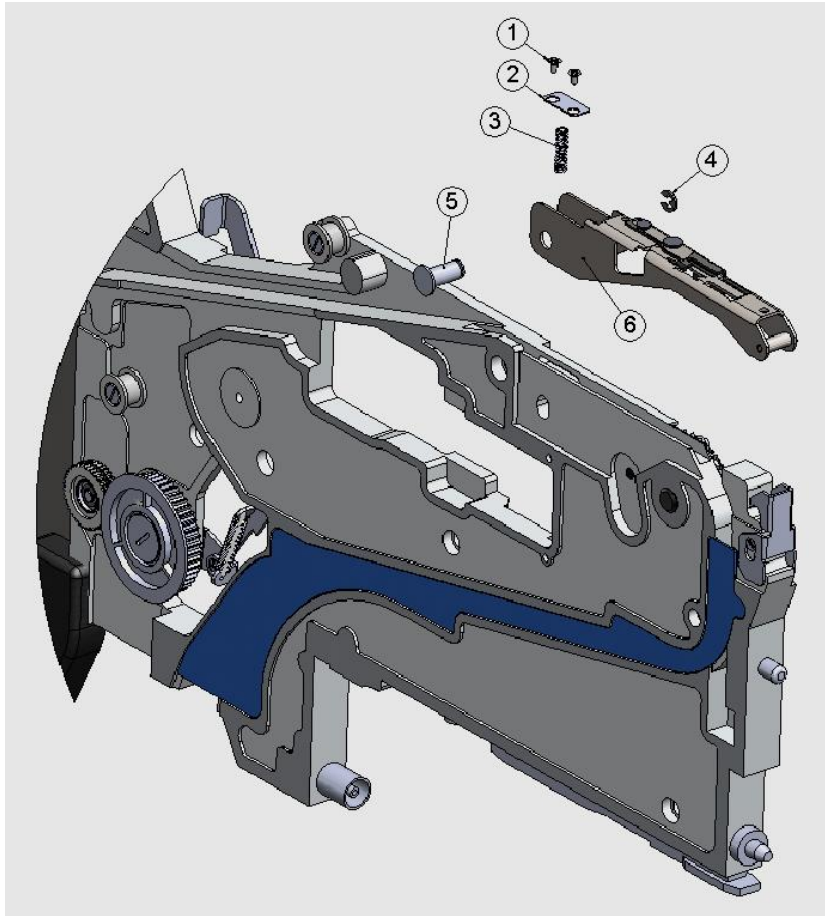

### SM Feeder / Tape Guide Removal / Installation

Before installing the Feederfinger, it is important to follow the instructions below to prevent the loss of feeder parts.

1. Remove the two Philips head screws (1) and spring retaining plate (2) On the top surface of the feeder. Hold the spring loaded plate in place to prevent the spring (3) from escaping the feeder body.
2. Slide the retaining plate (2) thru the slot on the right side of the feeder being careful to retain the spring (3)
3. Remove the spring (3).
4. Remove the E-clip (4) that holds the retaining pin (5) and tape guide (6) to the feeder body.
5. Lift the original tape guide (6) from the feeder.
6. Install the Feeder Finger (9) and insert the retaining pin (5).
7. Place the E-clip (4) back onto the retaining pin (5).
8. Insert the spring (3) pushing it even with the top surface of the hole using a small Philips Head Screw Driver.
9. While holding the spring in place insert the spring retaining plate (2) thru the slot on the right-hand side of the feeder body.
10. Hold the retaining plate in place while screwing down the two Philips Head Screws.
11. The Feederfinger is now installed and ready for use.



**TAPE GUIDE REMOVAL**

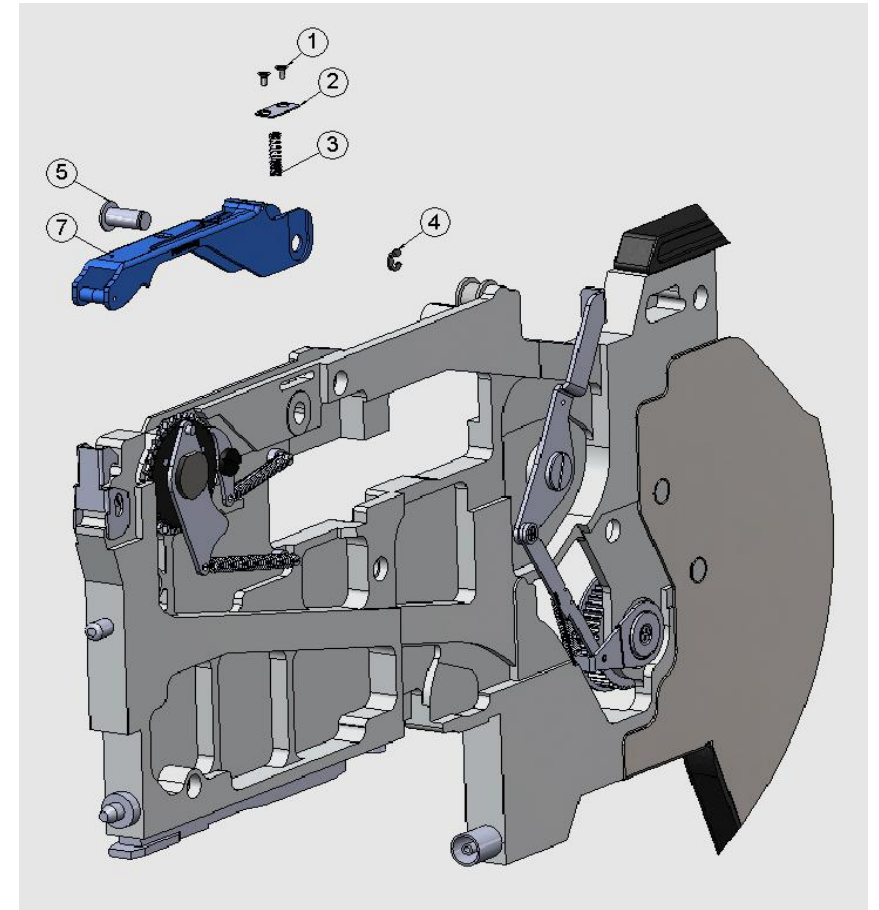

**FEEDER FINGER INSTALLATION**

## **How to use the Feederfinger Solution with Samsung's SM Feeders**

The Feederfinger Solution can be used to feed cut Component Tape as short as three inches or a full reel of components.

1. Before loading Component Tape into the Feederfinger cut the tape thru the sprocket hole, this will allow the tape to engage the sprocket easily.
  - a) When loading a short segment of Component Tape slide the tape into the rear of the Feederfinger until it reaches the tip of the blade.
  - b) Use your index finger to guide the tip of the blade between the Cover Tape and Carrier Tape.
  - c) Use the Tape Push Tool provided to push the Component Tape using the sprocket holes.
  - d) Push the Tape with the Tool until the Tape reaches the sprocket.
  - e) With your opposite hand push the feeder index lever and hold.
  - f) Push the tape onto the sprocket one click.
  - g) Your feeder is now ready to use.
  - h) Place the feeder on your pick and place or feeder cart.

### **When loading a full reel of components follow these steps:**

2. Before loading component tape into the Feederfinger cut the tape thru the sprocket hole, this will allow the tape to engage the sprocket easily.
  - a) Place a reel of tape onto the Reel Holder and feed the tape thru the natural path of the feeder.
  - b) Slide the tape into the feeder finger until it reaches the tip of the blade.
  - c) Use your index finger to guide the tip of the blade between the Cover Tape and Carrier Tape.
  - d) Use the Tape Push Tool provided to push the Tape using the sprocket holes.
  - e) Push the Tape with the Tool until the tape reaches the sprocket.
  - f) With your opposite hand push the feeder index lever and hold.
  - g) Push the tape onto the sprocket one click.
  - h) Your feeder is now ready to use.
  - i) Place the feeder on your pick and place or feeder cart.

The blue and green SM Feeder Fingers can only be used with paper tape a Feeder Finger dedicated for use with plastic tape is in the works.

For additional information visit [www.feederfinger.com](http://www.feederfinger.com)