

### TAPE GUIDE REMOVAL

#### CP Feeder / Tape Guide Removal

Before installing the feeder finger it is important to carefully follow the instruction below to prevent the loss of feeder parts.

- 1.) Remove the retaining clip that holds the retaining pin and tape guide to the feeder body.
- 2.) Before removing the pin place your thumb and forefinger over the two small holes on the left and right side of the tape guide.
- 3.) Remove the pin while holding the tape guide in place.
- 4.) Lift the tape guide away from the feeder body while keeping your thumb and forefinger in place to prevent losing the two ball bearings and springs housed in the feeder body.
- 5.) While holding the ball bearings and springs in place slide the feeder finger onto the feeder body being careful not to allow the ball bearings and spring to escape their resting place.
- 6.) With the feeder finger, ball bearings, and springs in place align the feeder finger with the attachment holes in the feeder body and insert the retaining pin.
- 7.) Re-attach the retaining clip and the feeder is ready for use.

ITEM NO.	PART NUMBER	QTY.
1	FEEDER EXISTING	1
2	BEARING EXISTING	2
3	TAPE GUIDE EXISTING	1
4	SPRING EXISTING	1
5	RETAING CLIP EXISTING	1
6	RETAING PIN EXISTING	1

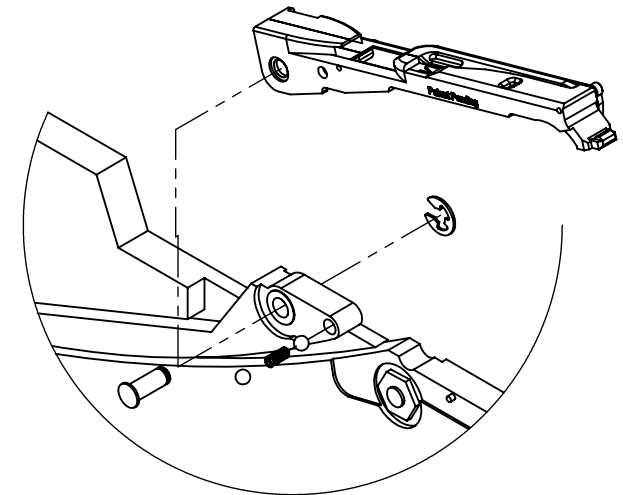

### FEEDER FINGER INSTALLATION

## DETAIL B

SCALE 1 : 2

## How to use the Cut Tape Feeder Finger with CP Feeders

The Cut Tape Feeder Finger can be used to feed cut component tape as short as five inches or a full reel of components.

1. Before loading component tape into the feeder finger cut the tape thru the sprocket hole, this will allow the tape to easily engage the sprocket.
  - a) When loading short segments of component tape slide the tape into the rear of the feeder finger until it reaches the spring platform.
  - b) Unlatch the feeder finger and place the component tape on top of the spring platform and re-latch the feeder finger.
  - c) Using tweezers guide the component tape using the sprocket holes thru the sprocket hole opening adjacent to the blade.
  - d) When the tape reaches the tip of the blade guide the blade between the top cover and carrier tape.
  - e) Using the tweezers push the tape until it reaches the sprocket.
  - f) With your right hand index the push roller on the front of the feeder two clicks.
  - g) While pushing the tape with the tweezers release the push roller.
  - h) The first component should now be at the pick opening.
  - i) Place the feeder on your pick and place or feeder cart.

### When loading a full reel of components follow these steps:

2. Before loading component tape into the feeder finger cut the tape thru the sprocket hole, this will allow the tape to easily engage the sprocket.
  - a) Unlatch the feeder finger and place the reel of component tape thru the natural path of the feeder until it reaches the spring platform.
  - b) With the tape resting on the spring platform re-latch the feeder finger.
  - c) Using tweezers guide the component tape using the sprocket holes thru the sprocket hole opening adjacent to the blade.
  - d) When the tape reaches the tip of the blade guide the blade between the top cover and carrier tape.
  - e) Using the tweezers push the tape until it reaches the sprocket.
  - f) With your right hand index the push roller on the front of the feeder two clicks.
  - g) While pushing the tape with the tweezers release the push roller
  - h) The first component should now be at the pick opening.
  - i) Place the feeder on your pick and place or feeder cart

For additional information about the Cut Tape Feeder Finger visit [www.feederfinger.com](http://www.feederfinger.com)